



6 La Trobe Street Warrnambool VIC

8 🏠 4 🚗 4 🚗

Located on a large allotment on the corner of Latrobe and Foster Street only a few meters from the waters edge are these 4 fully occupied 2 bedroom units. The options are plentiful for this outstanding site, update the existing properties or organise planning for new developments while earning an excellent return or live in one and make improvements to the others as time permits. The options are endless but these sites are scarce and views cannot be diminished.

- 2 bedrooms with BIR.
- Bathroom with shower and WC.
- Open plan kitchen with electric appliances and dining.
- Carport
- Electric heating and hot water services.

[For full version visit the website](#)

Type : Block of Units
Price : \$1,465,000 to \$1,600,000
Land Size : 593 sqm
View : <https://www.falk.com.au/sale/vic/warrnambool-port-fairy/warrnambool/residential/block-of-units/7681299>



Gary Attrill
03 5561 1677

1 FOSTER STREET, WARRNAMBOOL, VIC

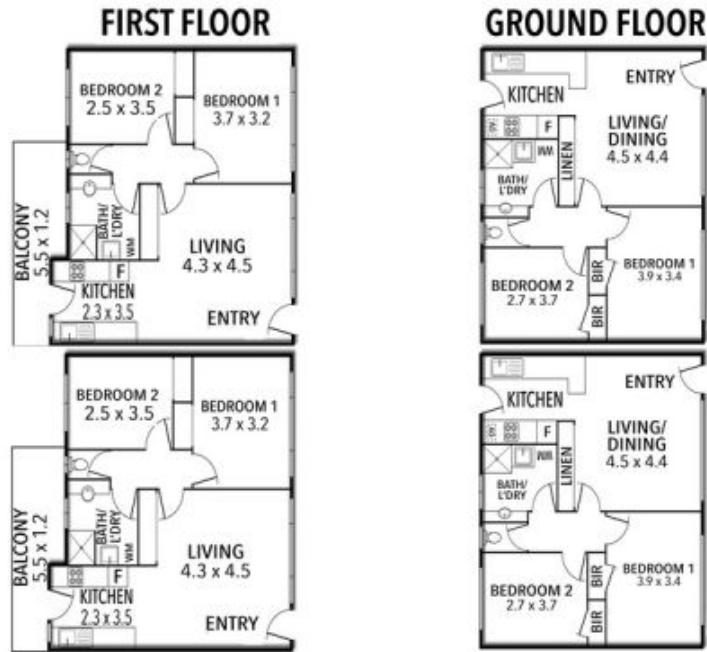

THE ABOVE PLAN IS AN ARTIST'S IMPRESSION ONLY, IT INCLUDES ELEMENTS THAT ARE FOR DISPLAY PURPOSES ONLY AND MAY NOT BE TO SCALE. LANDSCAPING SHOWN IS INDICATIVE ONLY. DIMENSIONS ARE APPROXIMATE.